

autosan ECONO

v12013

1

STANDARD AND OPTIONAL PARTS

PARTS LIST (included with each unit)

QTY	Part #	Description
A	1	43243 Key
B	2	80812 Screws
C	1	SD40255 Silicone Tubing 3.6 mm
D	1	SD40313 PE WhiteTubing 6.5 mm
E	1	SD15630 Tube Clip & SS Screw

OPTIONAL PARTS

F	SD15640	6.3 mm Stainless Steel Tube (100cm)
J	SD15610	SS Heavy Clamps (incl screws)
H	SD40329	Back Flow Check Valve
D	SD40313	PE WhiteTubing 6.5 mm (per M)

3

INSTALLATION TYPES

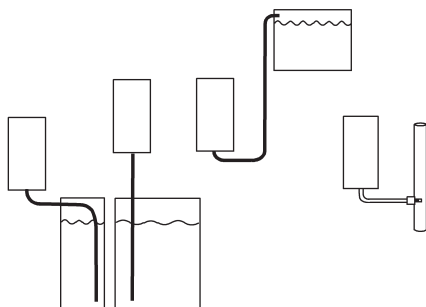

2

TO OPEN COVER....
PUSH KEY IN
PULL COVER OUT FROM TOP

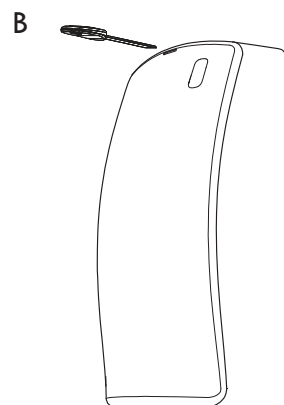

4

PLAN AND PREPARE TUBING

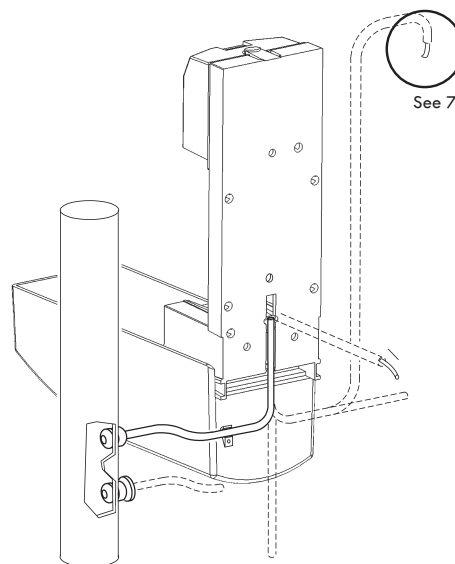

5

ATTACH PLASTIC OR STAINLESS STEEL TUBING TO WALL

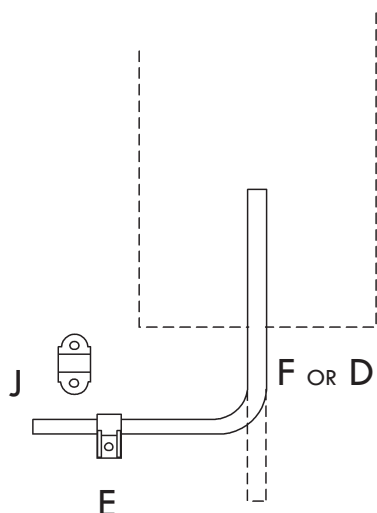

6

ATTACH TO WALL

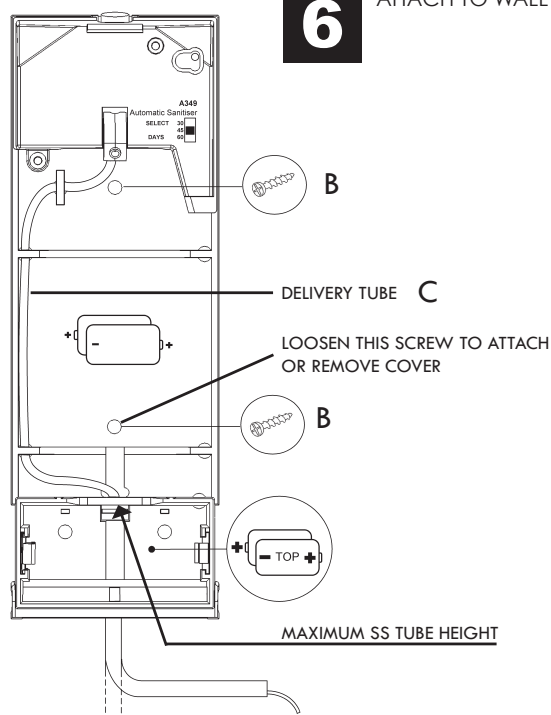

Allegro[★] autosan ECONO

7

ATTACH BACK FLOW VALVE

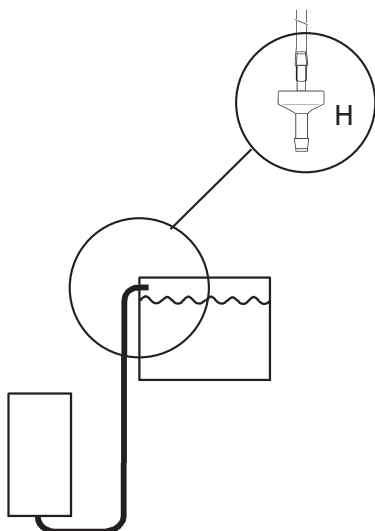

8

INSERT TWO D SIZE BATTERIES THEN REFILL
USE ALKALINE BATTERIES ONLY

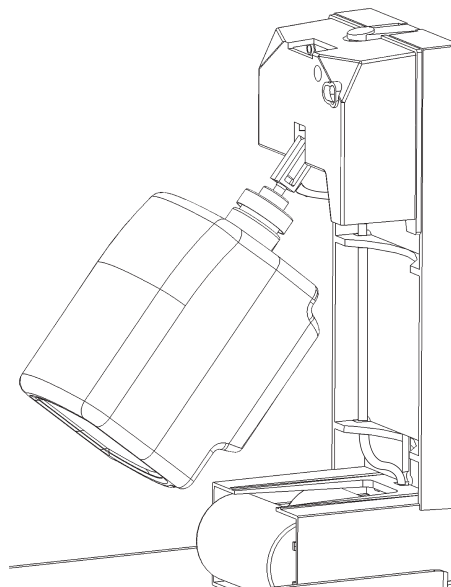

9

PRIME REFILL

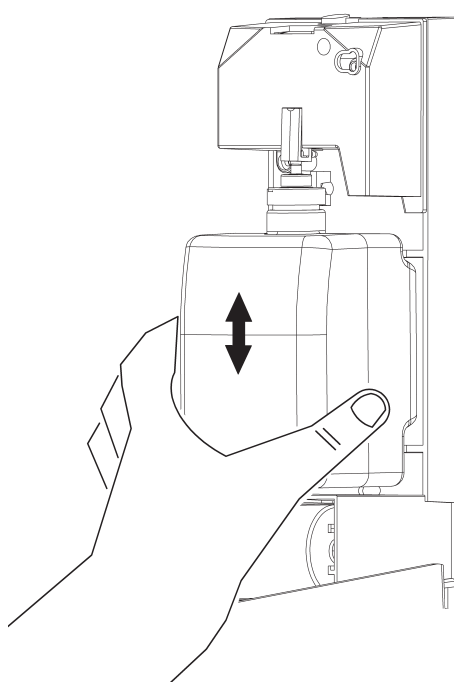

10

SET SERVICE PERIOD

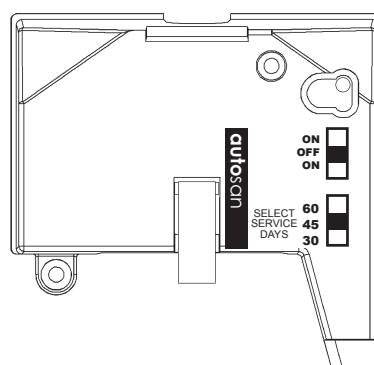

Days Setting approximate refill life	Activation Interval minutes	Milimetres pumped per day
30	8	14
45	12	10
60	16	07

This model of pump dispenser runs 24/7